

Stadtwerke Düsseldorf AG [Germany]



Electricity, gas, water and heat distribution

Stadtwerke Düsseldorf AG is the public utility company that supplies the city of Düsseldorf, capital of the largest German state Nordrhein-Westfalen, and its vicinity with electric energy, gas, water and heating.

Barco answers needs for dynamic visualization

In 1998 Stadtwerke Düsseldorf AG started investigating how their standalone control systems and control rooms could be combined in one control center. Its primary goals were to increase operational efficiency, provide high-quality services, and substantially reduce costs.

After careful investigation, it became clear that the 'cockpit control room', with monitors controlling all facilities, no longer met the needs of their increasingly complex system. The new system would need to enable the overview, control and management of content like detailed geographic information based on Geographic Information Systems (GIS), with plenty of additional schematics, electric distribution networks, gas pipelines, etc. The system's complexity prompted a full-scale test on a large display wall. This enabled the customer to view a dynamic display and control all relevant information real time.



BARCO

Visibly yours

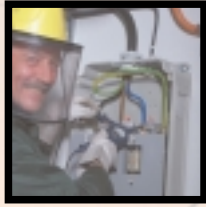

In the control center at Stadtwerke Düsseldorf AG, the energy network management area is equipped with a 4x3 OverView mP50 rear-projection display wall and the technical service center with a 3x3 OverView mP50 rear-projection display wall, both controlled by Barco's Eos graphics controllers

High reliability and lifetime system support

In 2001, the decision was made to install one control center with 2 independent functional areas: one area would manage the electric energy, gas, water and heating network, and the other would be used as a technical customer service center. Both areas would be located within the same premises, allowing contact between the operators, however there would be a clear physical and organizational separation. Each area was designed for 3 operators and equipped with its own display wall, primarily dedicated to geographic information, network overview, and alarm lists. The German PSI AG, one of the market leaders for network management software for electric and gas utilities, was chosen as general contractor and software supplier.

Barco installed a 4x3 OverView mP50 display wall in the energy network management area and a 3x3 OverView mP50 wall in the technical service center, both controlled by Barco's Eos graphics controller.

Peter Aymanns, Project Manager and head of the control center, states that Barco's display walls were chosen because of their outstanding display quality. Mr Aymanns added, "Control centers such as our new control center at Stadtwerke Düsseldorf AG are long term investments, thus only reliable suppliers can be considered. With Barco, we're sure that spare parts and repair services will be available even after 10 years from now."

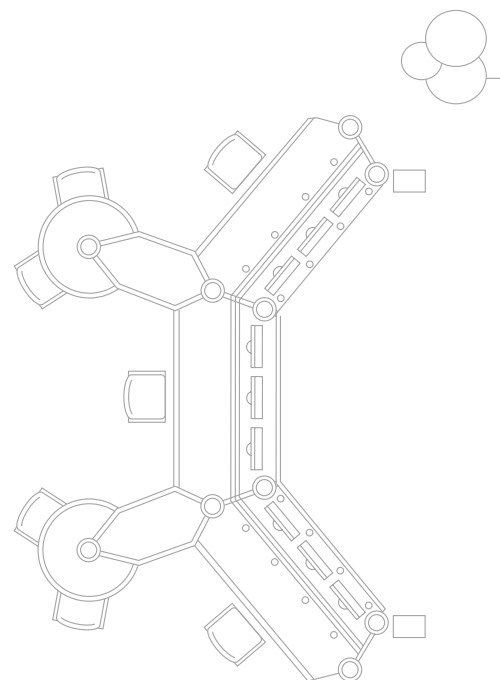

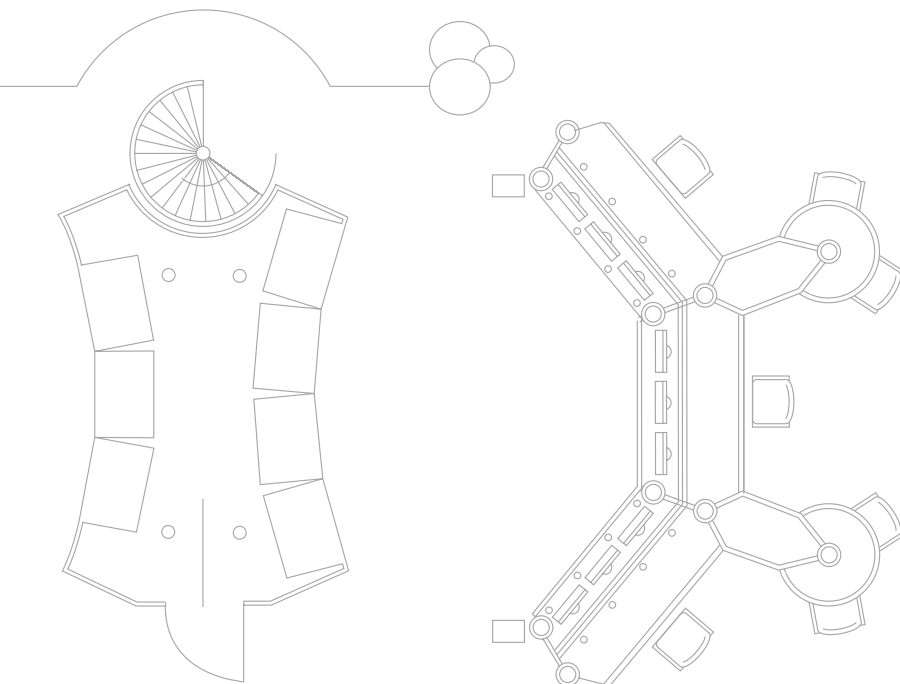

The unique concept of the control center - 2 functionally independent areas, one to manage the electric energy, gas, water and heating network, the other a technical customer service center



Efficient information display

Each operator has access to all network data and information, allowing flexible and situational task assignments. PSI's smooth zooming and panning functionality on large network pictures allows operators to access all information and efficiently manage the electric, gas, water and heating distribution networks, even concurrently with multiple cursor functionality.

The technical service center answers around 400,000 calls per year and provides virtually instant customer assistance, using the display wall as major source of information.

The new control center not only allows Stadtwerke Düsseldorf AG to reduce costs by housing the formerly separated control rooms under one roof, it also increases operational efficiency, which contributes to its high quality of service and customer satisfaction.

Ref. no. R599677 November '03

Barco Control Rooms is an ISO 9001 registered company.
The information and data given are typical for the equipment described. However any individual item is subject to change without any notice.
The latest version of this product sheet can be found on www.barcocontrolrooms.com
© January 2002 by Barco

Barco Control Rooms - Belgium
Noordlaan 5, 8520 Kuurne
Phone (32) (56) 368211
E-mail sales.bcd@barco.com

Germany Phone (49) (721) 62010
USA Phone (1) (770) 2183200
Brazil Phone (55) (11) 38421656
Japan Phone (81) (3) 57628720
Hong Kong Phone (852) 23970752

BARCO

Visibly yours

www.barcocontrolrooms.com